

- 1.0 PERFORMANCE
 1.1 FREQUENCY RANGE: DC-7.5GHz
 1.2 VOLTAGE RATING: 2700V RMS (sea level)
 1.3 NOMINAL IMPEDANCE: 50 OHMS
 1.4 DWV: 4000 V RMS @ 60 Hz (sea level)
 1.5 TEMPERATURE RANGE: -55° C TO +155° C
 1.6 INSULATION RESISTANCE: 10000 MEGOHMS MIN.
 1.7 VSWR TYP: <1.03 (DC-5 GHz)
 <0.90+.026F (5-7.5 GHz)
 1.8 IM3 < -174 dBc

- 2.0 MATERIALS
 2.1 DIELECTRICS: PTFE
 2.2 FEMALE CONTACT: PHOSPHOR BRONZE
 2.3 BODY: BRASS
 2.4 O-RINGS: SILICONE RUBBER, GR. 70
 3.0 FINISHES: SEE TABLE
 4.0 MECHANICAL
 4.1 INTERFACE PER IEC 169-4 (ø.232 ENHANCEMENT)
 4.2 CONTACT CAPTIVATION TORQUE: 64 IN*OZ

DWG NO. OL-1906-53-1		REV. B
PART NUMBER	BODY	CONTACT
1906-53-AS	ALBALOY	SILVER
1906-53-SS	SILVER	SILVER

PLATING PER SAN-TRON SPEC. 7.3.1-8

DO NOT SCALE DRAWING

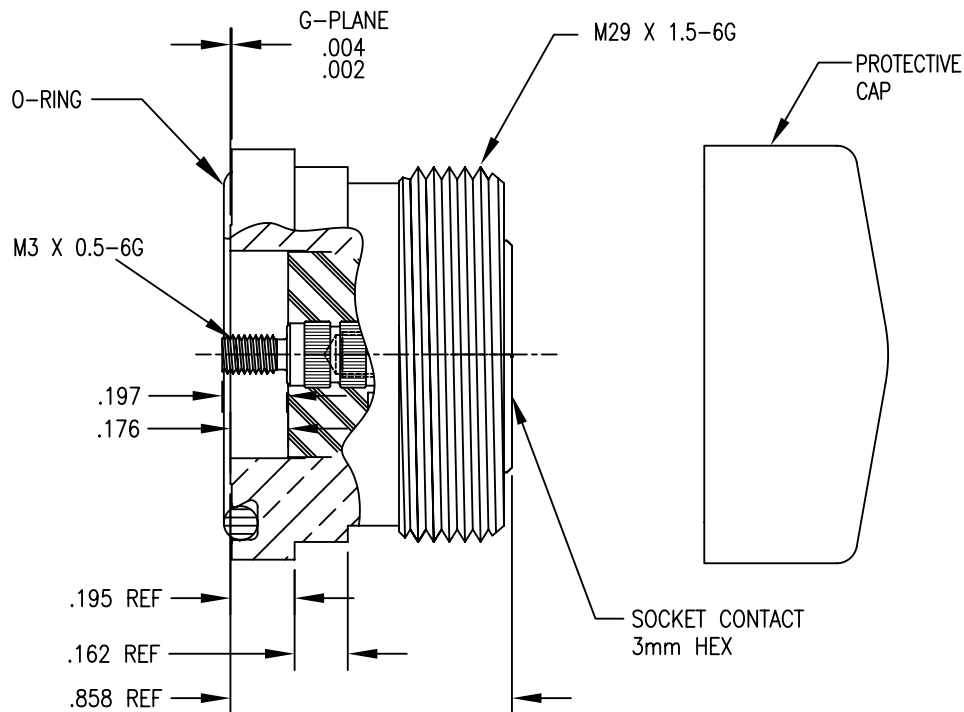
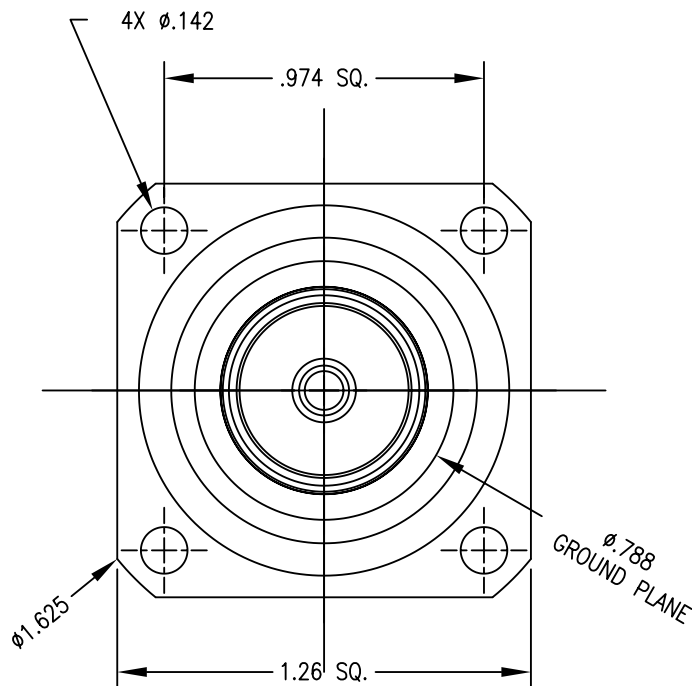

Rev.	Revisions	Disp.	Date	Dwn.	Appd.
B	UPDATE IMPROVED RF PERFORMANCE	FIFO	2/20/08	JTH	FSH
A	PRODUCTION RELEASE	NEW	11/28/07	JTH	FSH
1	PRELIMINARY: DO NOT MFG	NEW	11/27/07		

Ref.: SK-070615-3-1	REMOVE ALL BURRS AND SHARP EDGES .005 MAX.	INTERPRET PER ASME Y14.5M-1994
------------------------	--	--------------------------------

THIS DRAWING CONTAINS CONFIDENTIAL INFORMATION PROPRIETARY TO SAN-TRON, INC. IT MUST NOT BE REPRODUCED OR DISCLOSED TO OTHERS OR USED IN ANY OTHER WAY, IN WHOLE OR PART EXCEPT AS AUTHORIZED IN WRITING BY SAN-TRON, INC.

UNLESS OTHERWISE SPECIFIED:
 ALL DIMENSIONS ARE IN INCHES.
 ALL DIMENSIONS ARE AFTER PLATING.
 .XXX= ±.005 ALL MACHINED SURFACES 32/ MAX.
 .XX= ±.01 ANG.±1/2° FRACTIONAL= ±1/64
 ◎.004 MAX. TIR ⊥ AXIS .001

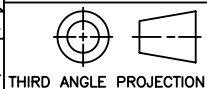

DWN	JTH	11/27/07
CHKD	SJS	11/28/07
APPR	FSH	11/28/07



SAN-TRON, INC.

4 NEWBURYPORT TPK. IPSWICH MA USA 01938
 TEL: 978-356-1585 FAX: 978-356-1573
 WWW.santron.com E MAIL: santron@santron.com

TITLE 7/16 PANEL RECEPTACLE
 STRAIGHT, FEMALE, PANEL SEALED

MATERIAL: FINISH:
 SEE TABLE

CAGE CODE: 50896	DWG NO. OL-1906-53-1	REV. B
SCALE X:X		