

- 1.0 PERFORMANCE
 1.1 FREQUENCY RANGE: DC-6 GHz
 1.2 VOLTAGE RANGE: 1000V RMS (sea level)
 1.3 NOMINAL IMPEDANCE: 50 OHMS
 1.4 DWV: 2500V RMS @ 60Hz (sea level)
 1.5 TEMPERATURE RANGE: -65°C TO +165°C
 2.0 MATERIALS
 2.1 DIELECTRIC: PTFE

- 2.2 CENTER CONTACT: BERYLLIUM COPPER
 2.3 ALL OTHER METAL PARTS: BRASS
 3.0 FINISHES: SEE TABLE
 4.0 MECHANICAL
 4.1 INTERFACE IN ACCORDANCE WITH MIL-STD-348

DWG NO. OL-0411-04-1	REV. D	
PART NUMBER	BODY	CONTACT
0411-04	NICKEL	GOLD/Ni
0411-04-AS	ALBALOY	SILVER
0411-04 Si/GOLD	SILVER	GOLD/Ni
UG-997A/U	NICKEL	SILVER
UG-997A/U AL/GOLD	ALBALOY	GOLD/Cu
UG-997A/U-NJ	NICKEL	GOLD/Ni
UG-997A/U Si	SILVER	SILVER
UG-997A/U Si/GOLD	SILVER	GOLD/Ni

PLATE PER STI 7.3.1-8

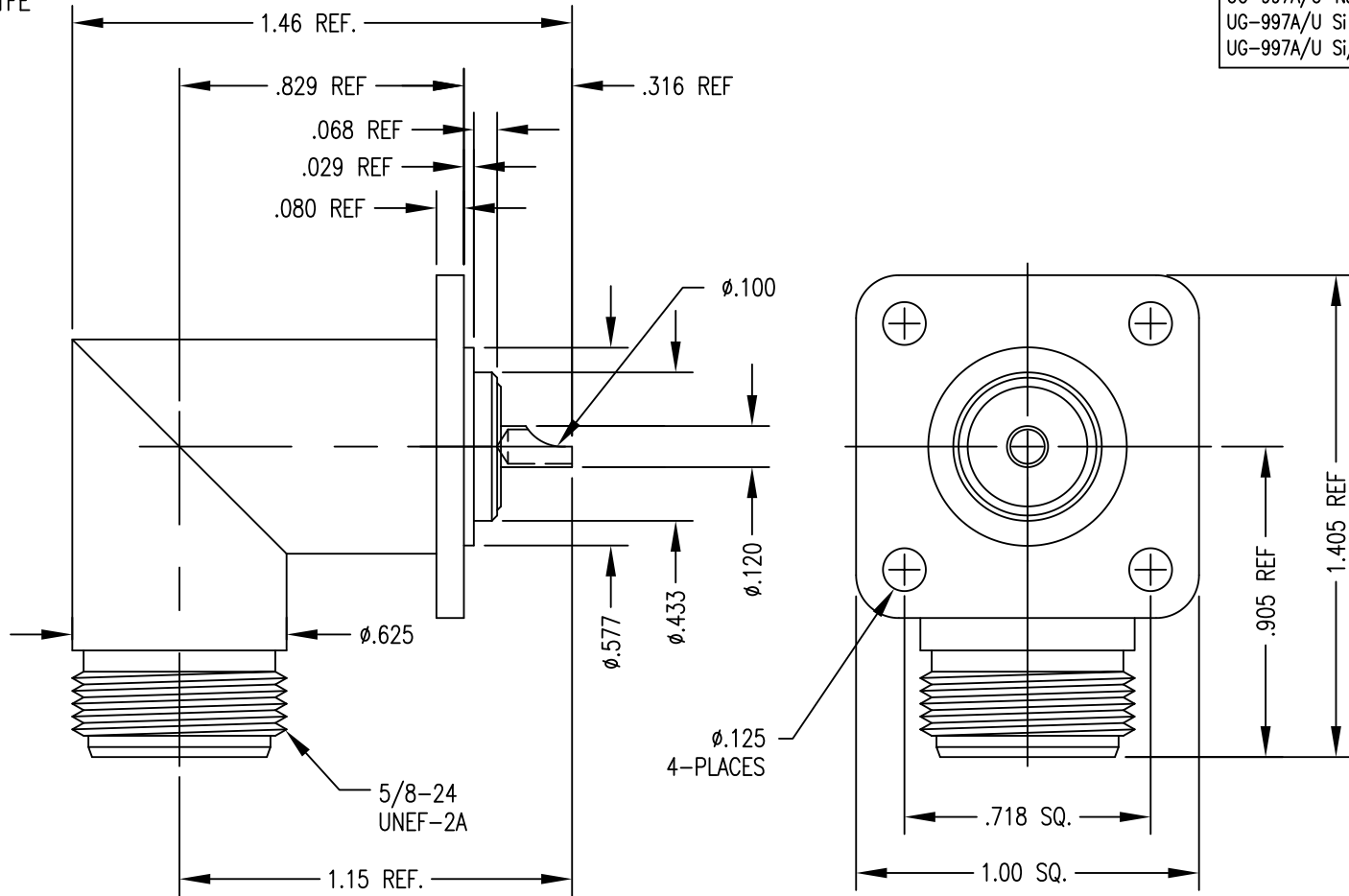

THIS DRAWING CONTAINS CONFIDENTIAL INFORMATION PROPRIETARY TO SAN-TRON INC. IT MUST NOT BE REPRODUCED OR DISCLOSED TO OTHERS OR USED IN ANY OTHER WAY, IN WHOLE OR PART EXCEPT AS AUTHORIZED IN WRITING BY SAN-TRON INCORPORATED.



SAN-TRON, INC.

4 NEWBURYPORT TPK. IPSWICH MA USA 01938
 TEL: 978-356-1585 FAX: 978-356-1573
 WWW.santron.com E MAIL: santron@santron.com

D	ADD PLATING CODE "-NJ"	NEW	12/14/09	FSH	FSH
C	ADD UG-997A/U TO TABLE	FIFO	1/24/08	FSH	FSH
B	UPDATE FROM 2GHZ UG-997A/U	FIFO	1/15/08	FSH	FSH
A	ORIGINAL	NEW	7/28/05		
Rev.	Revisions	Disp.	Date	Dwn.	Appd.
			REMOVE ALL BURRS AND SHARP EDGES .005 MAX.		INTERPRET PER ANSI Y14.5M-1982

UNLESS OTHERWISE SPECIFIED:
 ALL DIMENSIONS ARE IN INCHES.
 ALL DIMENSIONS ARE AFTER PLATING.
 ALL MACHINED SURFACES $63 \sqrt{\text{MAX}}$.
 .XXX = ±.005 .XX = ±.01 FRACTIONAL = ±1/64
 @.004 MAX. TIR. ANG. ± 1/2' ⊥ AXIS .001

DWN	LAP	7/28/05
CHKD	SJS	7/28/05
APPR	FSH	7/29/05

THIRD ANGLE PROJECTION

TITLE	N PANEL RECEPTACLE, FEMALE, RIGHT ANGLE	
MATERIAL:	SEE NOTE 2.0	FINISH: SEE NOTE 3.0
CAGE CODE:	50896	DWG NO. OL-0411-04-1
SCALE	2:1	REV. D